

Features

- ◇ 2.5 bellows.
- ◇ Good elasticity and high tensile strength.
- ◇ Good wear resistance and oil resistance.
- ◇ PU material. Long lifetime. The lifetime is 2–4 times longer than other material.



Applications

- ◇ Suitable for workpieces with uneven net-patterned surface.
- ◇ Suitable for plastic industry.

How to order

SGP 25 U – G1F

① ② ③ ④

① Series	② Diameter	③ Material & Hardness	④ Connection thread
SGP	25 – φ25mm 35 – φ35mm 45 – φ45mm 55 – φ55mm	U – PU 55 UD – PU 30	Nil – Suction cup only G1F – G1/8 Female thread G1M – G1/8 Male thread G2F – G1/4 Female thread G2M – G1/4 Male thread

Selection

Model/Connection thread	G1F	G1M	G2F	G2M	G3F	G3M
SGP25 – 45	●	●	–	–	–	–
SGP55	–	–	●	●	●	●

◇Note : "●"- default,in stock;"–"unavailable.

Technical parameters

Model	Pull-out force (N)	Inner volume (cm ³)	Min. curve radius of workpiece(mm)	Recommended hose diameter(mm)
SGP25	22	3	31	6
SGP35	43	6	42	6
SGP45	71	13	54	6
SGP55	106	23	64	10

◇ Note: Testing vacuum level: –60kPa. Testing Workpiece: smooth and clean surface. The data of pull-out force as above are figured out without considering safety factor. The data may be different according to different workpiece surfaces.

Dimensions(mm)

SGP25-55

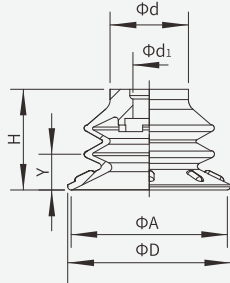

Model/Size	D	H	A	d	d ₁	Y
SGP25	25	15.5	24	12	5	5.5
SGP35	35	22.3	33.4	16.5	5	8.4
SGP45	45	29.3	42.8	16.8	6.6	11.5
SGP55	55	36.3	52.4	27.5	10.5	12.9

Female thread connection

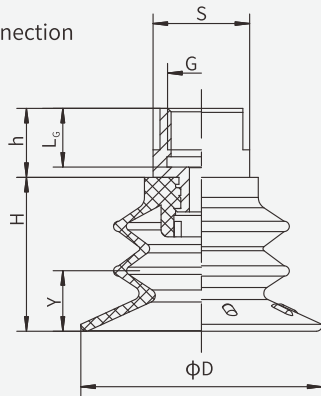

Male thread connection

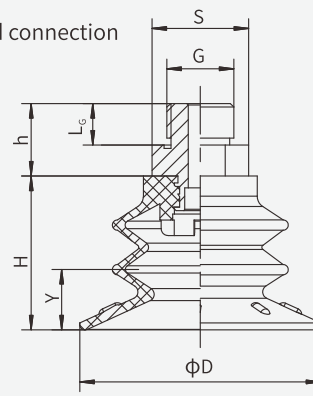

Model/Size	D	H	G	h	L _G	Y	S
SGP25-G1F	25	15.5	G1/8	8	7	5.5	13
SGP25-G1M	25	15.5	G1/8	7.8	6	5.5	13
SGP35-G1F	35	22.3	G1/8	8	7	8.5	13
SGP35-G1M	35	22.3	G1/8	7.8	6	8.5	13
SGP45-G1F	45	29.3	G1/8	10	7	11.5	17
SGP45-G1M	45	29.3	G1/8	12	6	11.5	17
SGP55-G2F	55	36.3	G1/4	13	10	13	24
SGP55-G2M	55	36.3	G1/4	17	9	13	24
SGP55-G3F	55	36.3	G3/8	13	11	13	24
SGP55-G3M	55	36.3	G3/8	18	10	13	24

Mounting parts

Item	Model		
	F - Female thread	M - Male thread	Applicable suction cup
Fitting for suction cup	PJS-G1F-SF1-EW	PJS-G1M-SF1-EW	SGP25, 35
	PJS-G1F-SF2-EW	PJS-G1M-SF2-EW	SGP45
	PJS-G2F-SF3-EW	PJS-G2M-SF3-EW	SGP55
	PJS-G3F-SF3-EW	PJS-G3M-SF3-EW	SGP55

◇ Note: Please refer to page 22 for mounting parts selection.

SB
SBA
SBB
SBF
SBOF
SFT
SFA
STP
SBL
SBLP
SBS
SF
SU
SUF
SFG
SFU
STC
SFF
SFM
SDM
SHT
SOFA
SOB
SOF
SOG
SFP
SBP
SXP
SGP
SDL
SH
SHB
SZ
SAN
SAO
SPA
SPC
SPF
SPJ
SPU
SNP
SOP